

High Pressure Resistant

5YR  
Warranty

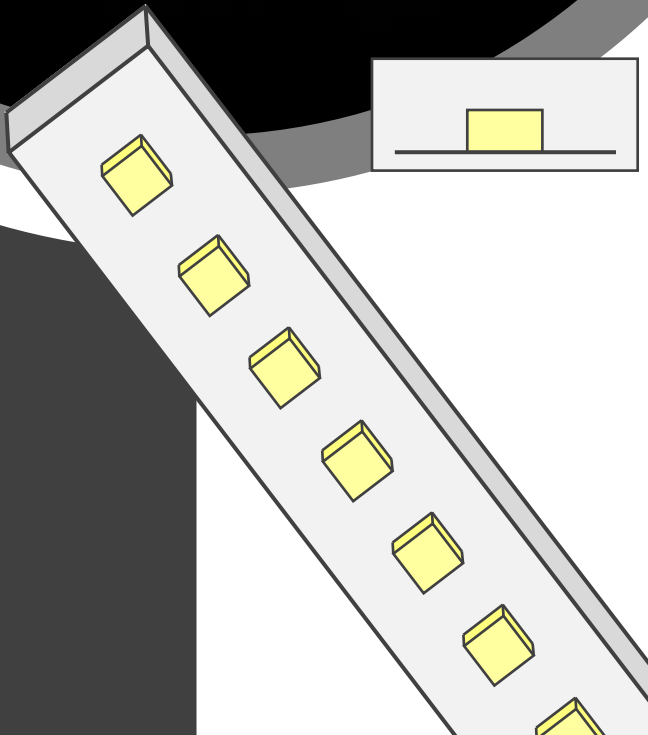

MODEL EPS50  
EMERGENCY LIGHTING  
POWER SUPPLY



iluminaTronics



# EMERGENCY LIGHTING POWER SUPPLY MODEL EPS50

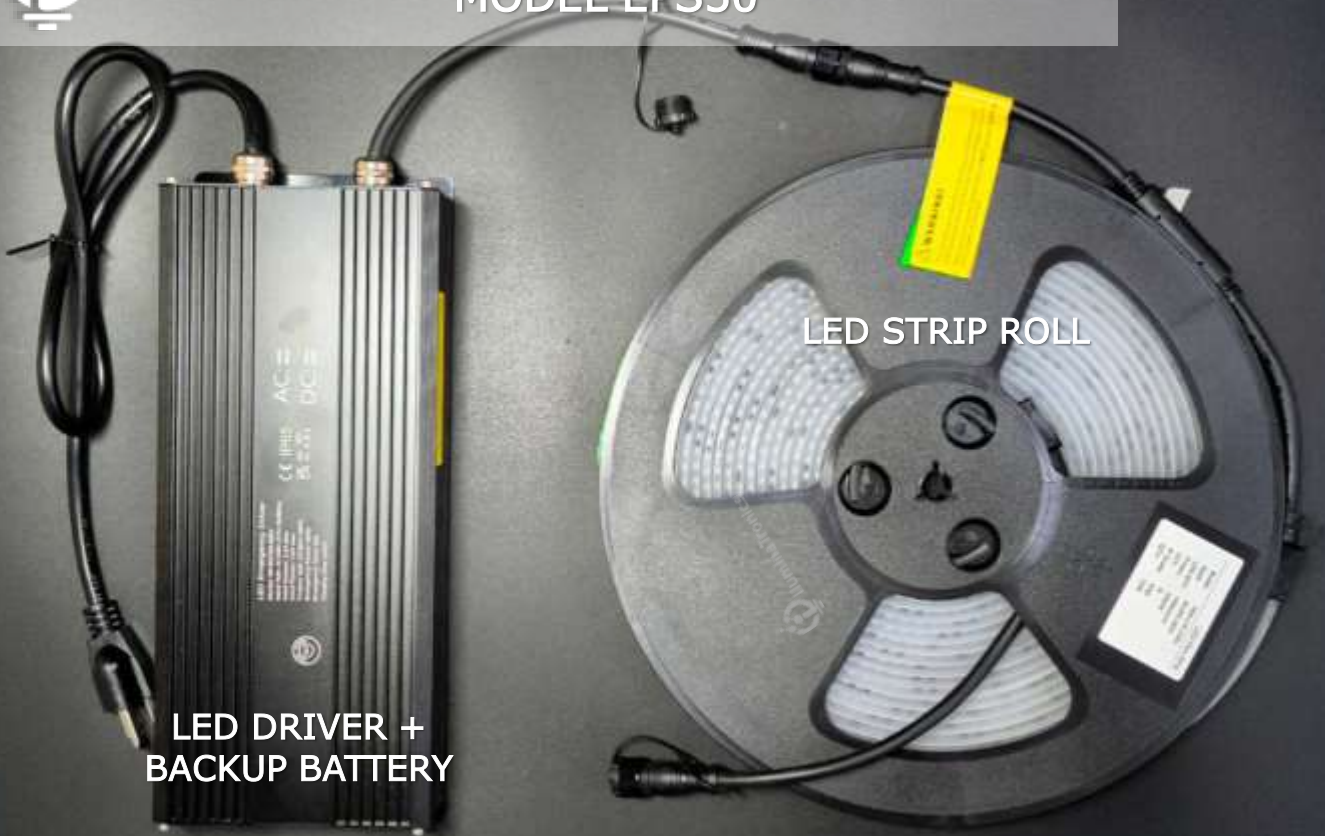

One power supply with backup battery can energize up to 50 m of LED strip for 120 minutes.

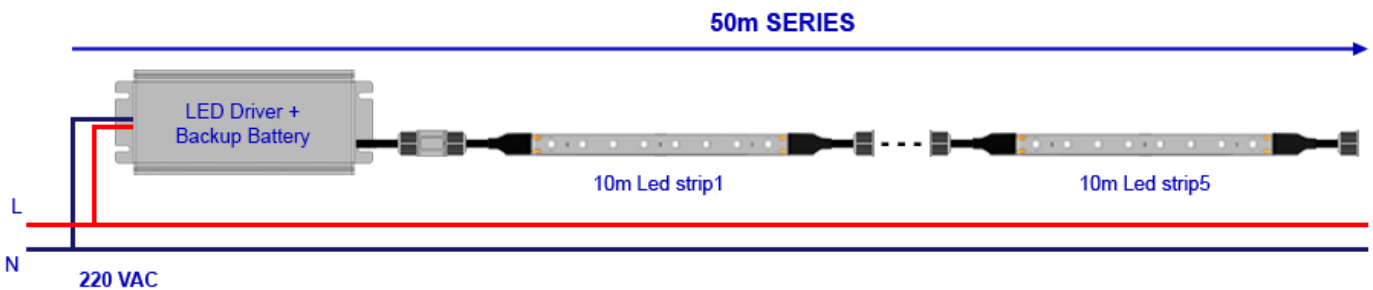



# EMERGENCY LIGHTING POWER SUPPLY SPECIFICATIONS MODEL EPS50



LED driver  
+ backup  
battery

Up to 50 m of LED strip in series





# EMERGENCY LIGHTING POWER SUPPLY SPECIFICATIONS MODEL EPS50

EMERGENCY POWER SUPPLY FOR LED STRIP LIGHTING	MODEL: EPS50
Model	EPS50
Input voltage	100 to 300 VAC
Input current	0.2 A
Illuminance of 50 m LED strip series (750 W) MODEL 15W-L10-230V-W	25 lux at 4 m mounting height (50 m LED strip series)
Output voltage	220 V
Operating frequency	50/60 Hz
Recharge time	24 h
Battery backup duration	120 minutes (50 m LED strip series)
Ambient operating temperature	-10°C to +50°C
Warranty	2 years
Dimensions	300 x 120 x 55 mm
Weight	2.95 kg

Green is commonly used as the emergency color; however, amber and blue are recommended because they provide better visibility through fog and smoke during fire emergencies.





iluminaTronics



**5YR**  
Warranty



iluminaTronics

www.iluminatronics.com  
United States of America

1211 San Dario Ave. #2068, Laredo, TX 78040 USA  
sales@iluminatronics.com  
Tel. USA: +1-941-893-2696

